

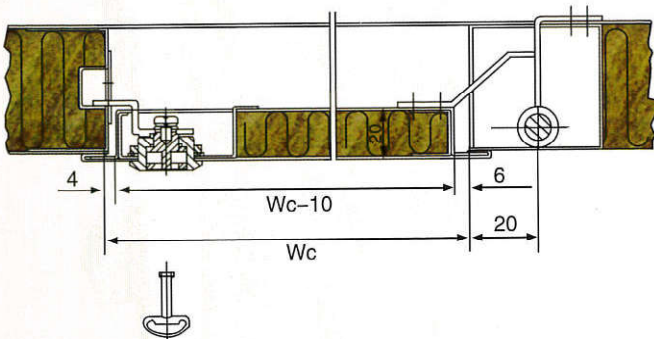

检修系统

Inspection System

舱室检修门 Repair Door

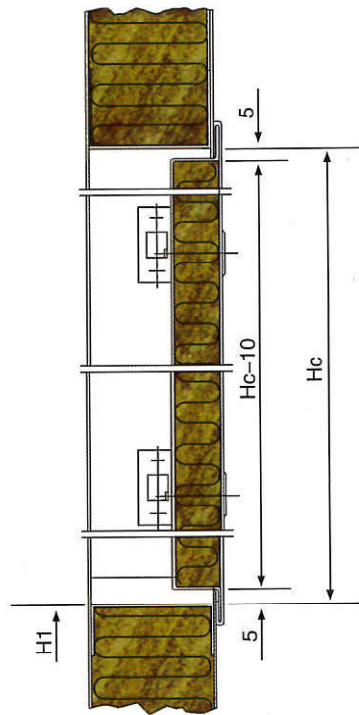

面材 Surface material	PVC贴塑钢板 0.6mm PVC laminated steel sheet
芯材 Core material	150kg/m ³ 岩棉 150 kg/m ³ Rockwool
防火等级 Fire Class	B-0
厚度 Thickness	25mm
门锁 Lock	铜镀铬或不锈钢 Chromeplated copper & Stainless steel
重量 Weight	13kg/m ²

检修系统

Inspection System

壁板检修门/Inspection Door

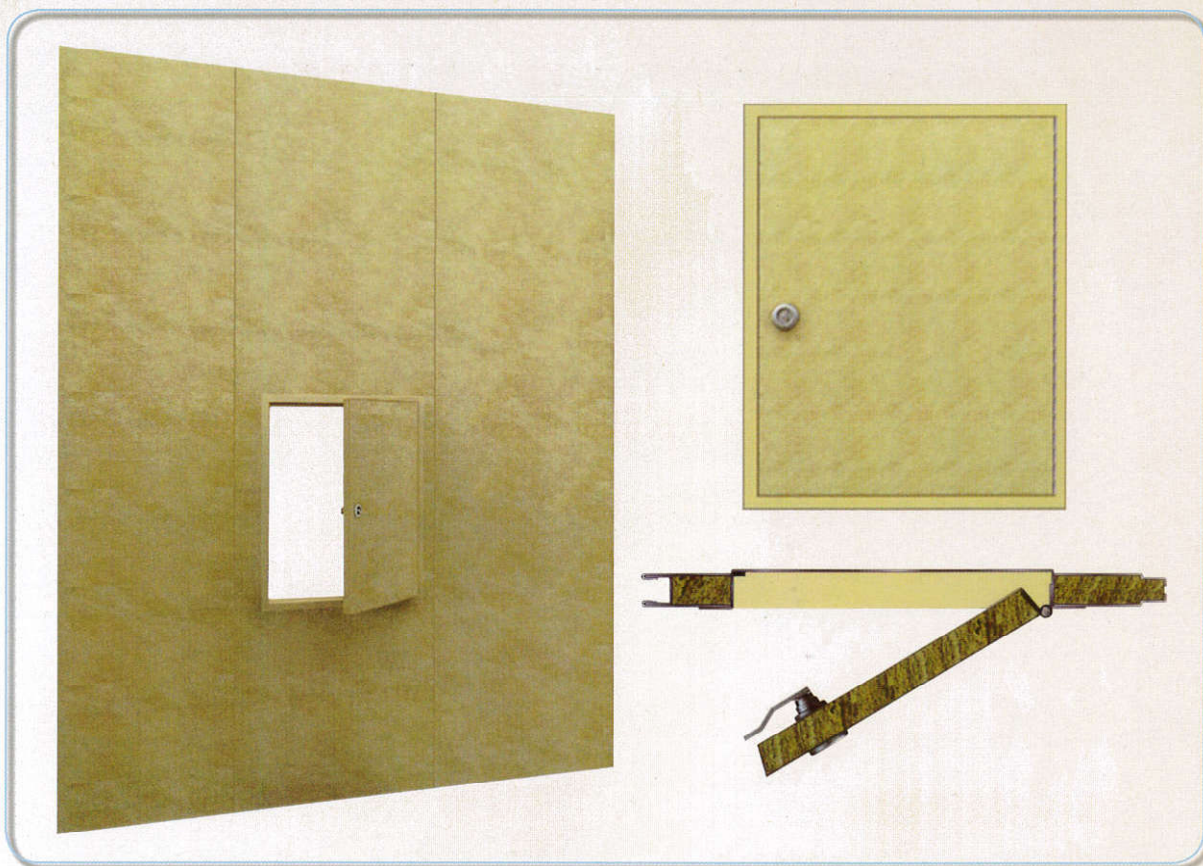

壁板检修门主要用于维修区。检修门以门框固定在25mm或者50mm的壁板上，门扇与门框用铰链相连，检修时用通用钥匙打开即可。门框的装饰为喷漆，颜色与壁板相近，门扇装饰面为PVC膜，颜色与壁板相同，当检修门高度 ≥ 500 时，门锁为两个，当检修门高度 < 500 mm时，门锁为一个。

This inspection door is mainly used in maintenance area. The door is fixed on the 25mm wall panel or 50mm wall panel by doorframe, the doorframe and door leaf are joined by hinge, when the maintenance area need to do inspection, we can open the door leaf. Door frame is decorated with paint spraying, which is similar color as the wall panel. Door leaf is finished by PVC film, its color is the same as the wall panel. There are two locks on the door as its height is 500 or bigger than 500mm, when the door height is smaller than 500mm, there is only one lock.

面材 Surface material	PVC贴塑钢板 0.6mm PVC laminated steel sheet
芯材 Core material	150kg/m ³ 岩棉 150 kg/m ³ Rockwool
防火等级 Fire Class	B-0
厚度 Thickness	25mm
门锁 Lock	铜镀铬或不锈钢 Chromeplated copper & Stainless steel
重量 Weight	13 kg/m ²

检修系统

Inspection System

天花板检修门/Inspection Door for Ceiling

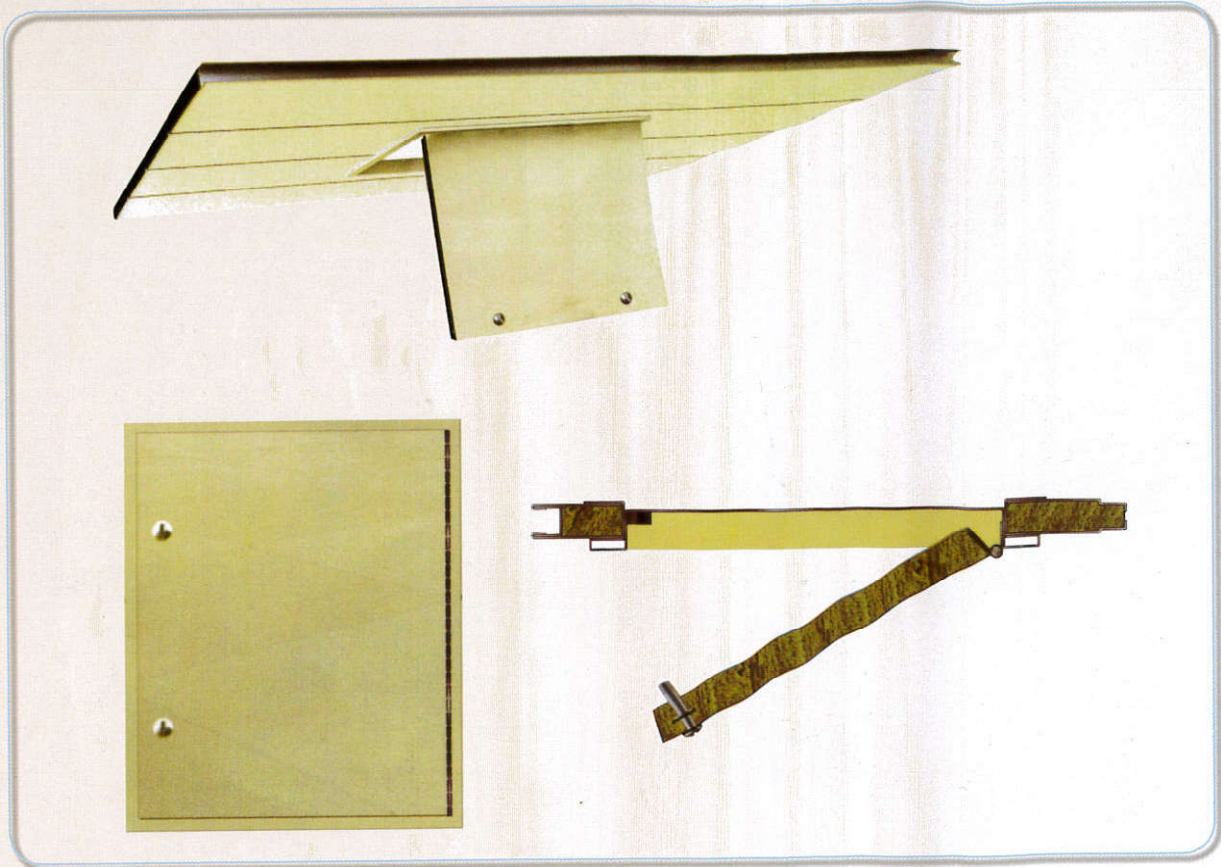

天花板检修门主要应用于天花板上的维修区。检修门以门框固定在25mm或者50mm厚的天花板上，门扇与门框用铰链相连，检修时用螺丝刀打开。检修门门框的装饰面为喷漆，颜色与天花板相近，门扇装饰面为PVC膜，颜色与天花板相同，当检修门尺寸>200时，检修门锁为两个，当检修门尺寸为≤200mm时检修门锁为一个。

This inspection door is mainly used in maintenance area. The door is fixed on the 25mm or 50mm ceiling by doorframe, the door frame and door leaf are joined by hinge, when the maintenance area need to do inspection, we can open the door with a screwdriver. The surface of the door frame is finished by spray painting, its color to be similar to the ceiling, the surface of the door leaf is finished by PVC film, its color to be same to the ceiling. There are two locks on the door as its length is bigger than 200mm, when the door length is 200mm or smaller than 200mm, there is only one lock.

面材 Surface material	PVC贴塑钢板 0.6mm PVC laminated steel sheet
芯材 Core material	150kg/m ³ 岩棉 150 kg/m ³ Rockwool
防火等级 Fire Class	B-0
厚度 Thickness	25mm
门锁 Lock	铜镀铬或不锈钢 Chromeplated copper & Stainless steel
重量 Weight	13 kg/m ²



检修系统

Inspection System

天花板检修门/Inspection Door for Ceiling

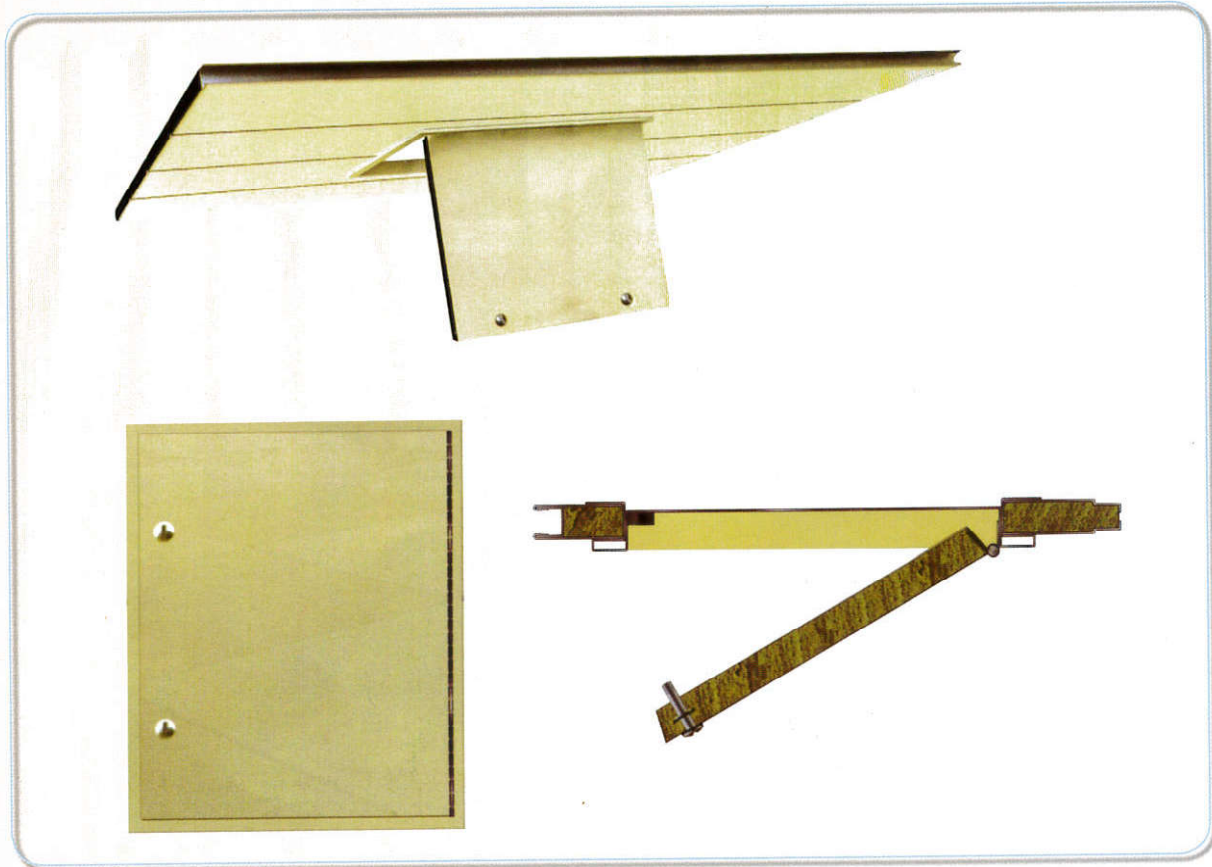

天花板检修门主要应用于天花板上的维修区。检修门以门框固定在25mm或者50mm厚的天花板上，门扇与门框用铰链相连，检修时用螺丝刀打开。检修门门框的装饰面为喷漆，颜色与天花板相近，门扇装饰面为PVC膜，颜色与天花板相同，当检修门尺寸>200时，检修门锁为两个，当检修门尺寸为≤200mm时检修门锁为一个。

This inspection door is mainly used in maintenance area. The door is fixed on the 25mm or 50mm ceiling by doorframe, the door frame and door leaf are joined by hinge, when the maintenance area need to do inspection, we can open the door with a screwdriver. The surface of the door frame is finished by spray painting, its color to be similar to the ceiling, the surface of the door leaf is finished by PVC film, its color to be same to the ceiling. There are two locks on the door as its length is bigger than 200mm, when the door length is 200mm or smaller than 200mm, there is only one lock.

面材 Surface material	PVC贴塑钢板 0.6mm PVC laminated steel sheet
芯材 Core material	150kg/m ³ 岩棉 150 kg/m ³ Rockwool
防火等级 Fire Class	B-0
厚度 Thickness	25mm
门锁 Lock	铜镀铬或不锈钢 Chromeplated copper & Stainless steel
重量 Weight	13 kg/m ²