

Product introduction

Huali rock wool is made from natural stone , melting at 1450 °C, centrifugal injection to kind of mineral fiber, add some thermosetting adhesives and additives etc, with the performance of non-combustible, non-toxic, low thermal conductivity, hydrophobic, sound absorption, etc. The roof insulation system consist of four types of single metal base flexible roof, double metal base roof, concrete base roof and tile slope roof systems.

Product performance

- Good insulation effect and fireproof performance
- Non-flammable, A1 grade. Fire rate is not affected and limited from the height of building.
- Better permeability, "berathing" the system.
- Higher compressive and tensile strength, make sure the using safety.
- Sound absorption, noise reduction
- Excellent hydrophobic performance, stable fiber structure, easy to cut and install
- Asbestos free, non-toxic

Single metal roof insulation system

The metal base flexible waterproof roofing system is a roofing system which mechanically fixes the single layer flexible rolling waterproof roofing system with rock wool as thermal insulation material to the metal base. The system has excellent waterproof, anti-seepage, anti-cracking and fire performance, which is an ideal

choice for metal roofing. It is suitable for the new construction and repair of metal roofing system of steel structure house, which is the ideal roofing structure of commercial and industrial buildings.

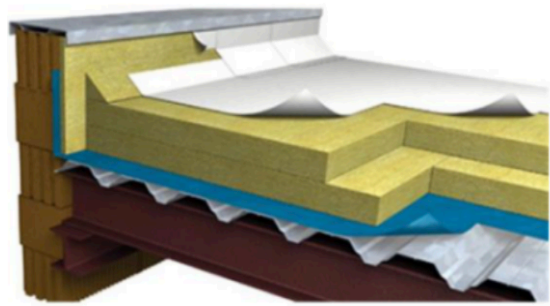

Type	Density	Thickness	Size
HLY RFSL45s	45 kg/m ³	50-150 mm	1200*600mm
HLY RFSL60s	60 kg/m ³	50-150 mm	1200*600mm
HLY RFSL80s	80 kg/m ³	40-150 mm	1200*600mm
Facing finish	Aluminum foil, glass fiber cloth etc		
Remark	special size please contact me directly		

Double metal roof insulation system

The double-layer metal roof is a system structure with vertical locking joints at the top or corrugated plates with aesthetic effect and rock wool insulation layer filled in the middle of the bottom pressed steel plate. It is a roofing solution meeting the requirements of fire prevention, sound insulation, weather resistance.

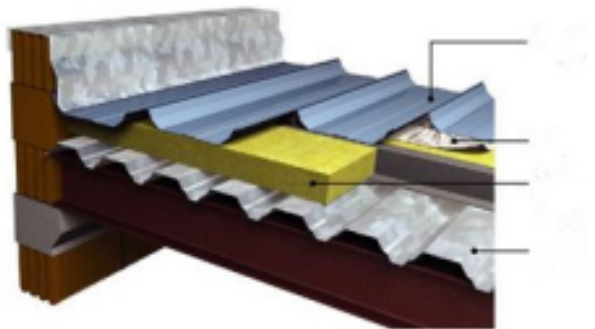

Type	Density	Thickness	Size
HLY RFSL45d	45 kg/m ³	50-150 mm	1200*600mm
HLY RFSL60d	60 kg/m ³	50-150 mm	1200*600mm
HLY RFSL80d	80 kg/m ³	40-150 mm	1200*600mm
HLY RFSL100d	100 kg/m ³	40-150 mm	1200*600mm
Facing finish	Aluminum foil, glass fiber cloth etc		

Concrete base roof insulation system

Due to the high heat storage of concrete, the concrete base roofing must be adequately insulated in summer and winter. The excellent insulation performance of Huali roof board can make the indoor temperature stable and the environment comfortable. In addition, Huali roof plate size is stable, will not be affected by climate diversity.

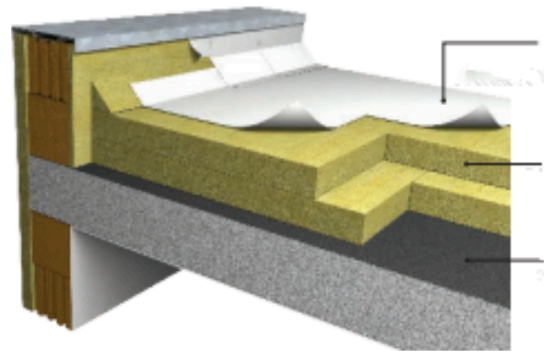

Type	Density	Thickness	Size
HLV RFSL120c	120 kg/m ³	40-150 mm	1200*600mm
HLV RFSL140c	140 kg/m ³	40-130 mm	1200*600mm
HLV RFSL160c	160 kg/m ³	40-110 mm	1200*600mm
HLV RFSL180c	180 kg/m ³	40-100 mm	1200*600mm
Facing finish	Aluminum foil,glass fiber cloth etc		

Tile slope roof insulation system

Tile roof system is often used in the slope of more than 10% tile roof system, consist of the roof base, rock wool insulation layer, waterproof pad and various types of tile. The rock wool insulation layer is bonded to the roof base with bonded mortar. If necessary, Angle steel can be fixed to the roof base to prevent the sliding of the insulation material. This kind of tile roofing is often used in low-rise or multi-storey residential buildings.



Type	Density	Thickness	Size
HLV RFSL60t	60 kg/m ³	50-150 mm	1200*600mm
HLV RFSL80t	80 kg/m ³	40-150 mm	1200*600mm
HLV RFSL100t	100 kg/m ³	40-150 mm	1200*600mm
HLV RFSL120t	120 kg/m ³	40-150 mm	1200*600mm
Facing finish	Aluminum foil,glass fiber cloth etc		

Technical data

Item Name	Specification	Unit
Factor of heat conduction (Temperature 25°C)	≤ 0.040	W/m.k
Compression strength	≥ 40	Kpa
Tensile strength	≥ 7.5	Kpa
Combustion performance	non-inflammable,A0	-
Humidity resistance	< 1	%
water resistance	< 0.5	kg/m ²
Hydrophobic property	≥ 98	%
Dimensional stability	≤ 1.0	%
Acidity coefficient	≥ 1.6	-
Melting temperature	> 1000	°C
Service temperature	≤ 650	°C
Average diameter of fiber	≤ 7.0	um

Company: Tianjin Huali Thermal Insulation Building Material Co., Ltd 300451

Tel: 86 22 25212423 Fax: 86 22 25211666 Email: info@hualibw.com

